

Access to NetLine OPS++ and NetLine OpsLink starting from October 1st, 2024

Launch Netline OPS++ (or NetLine Opslink) and click “NetLine Ops++ Azure AD login”:

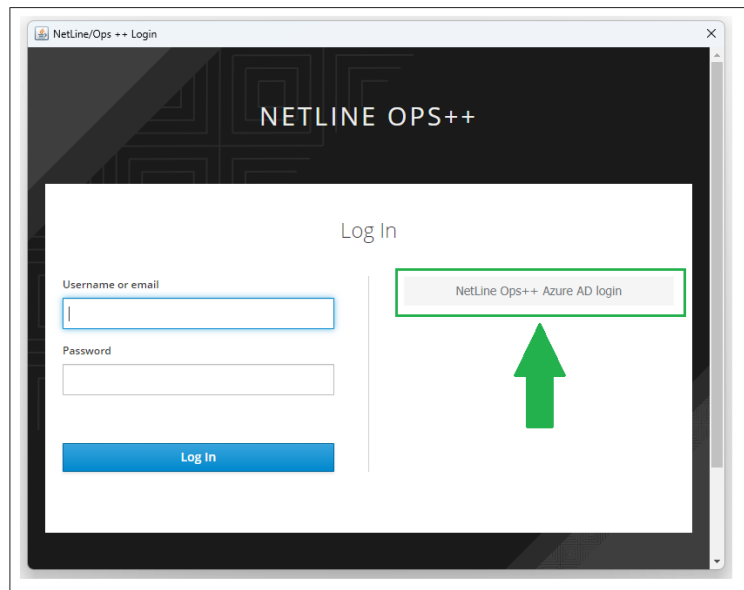

On the next screen enter your email address.

For non-ITA Airways users insert the assigned USERID followed by @ita-airways.com (eg: IHAA3456@ita-airways.com).

Then click 'Next':

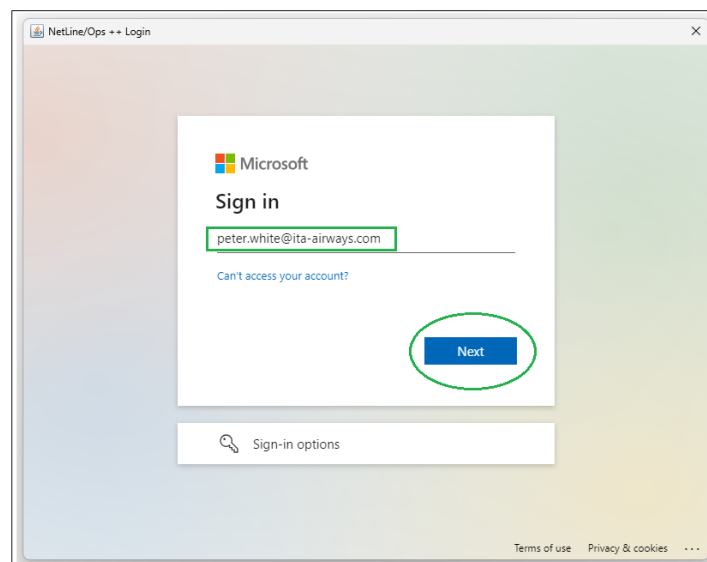

Enter your own password and click on 'Sign in':

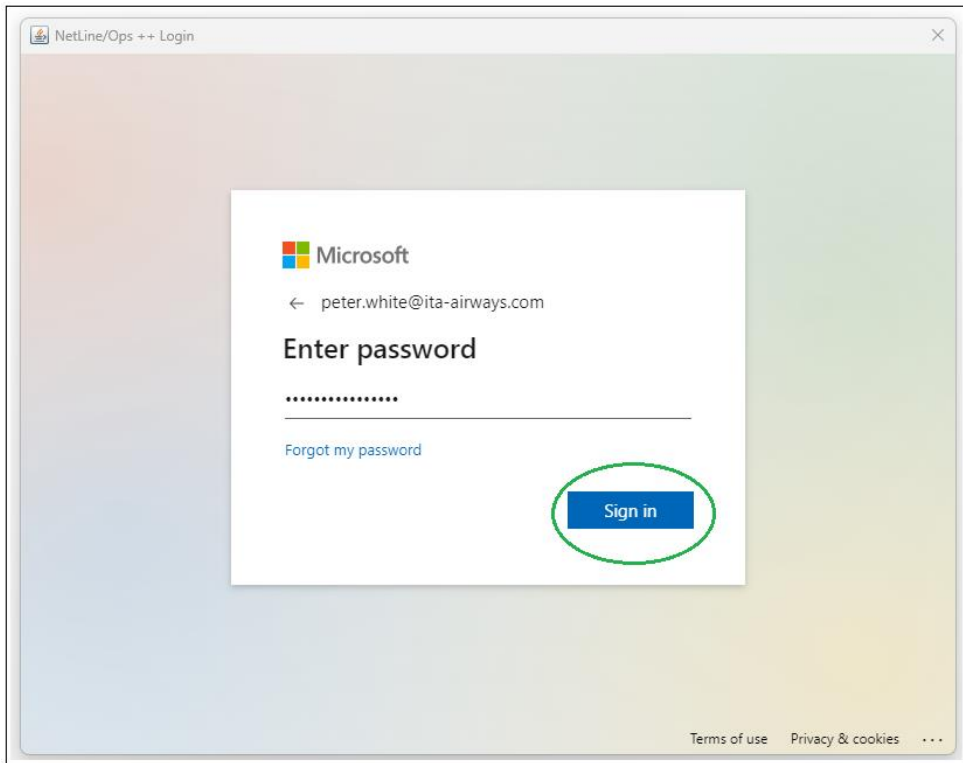

Click 'Yes' in the next window:

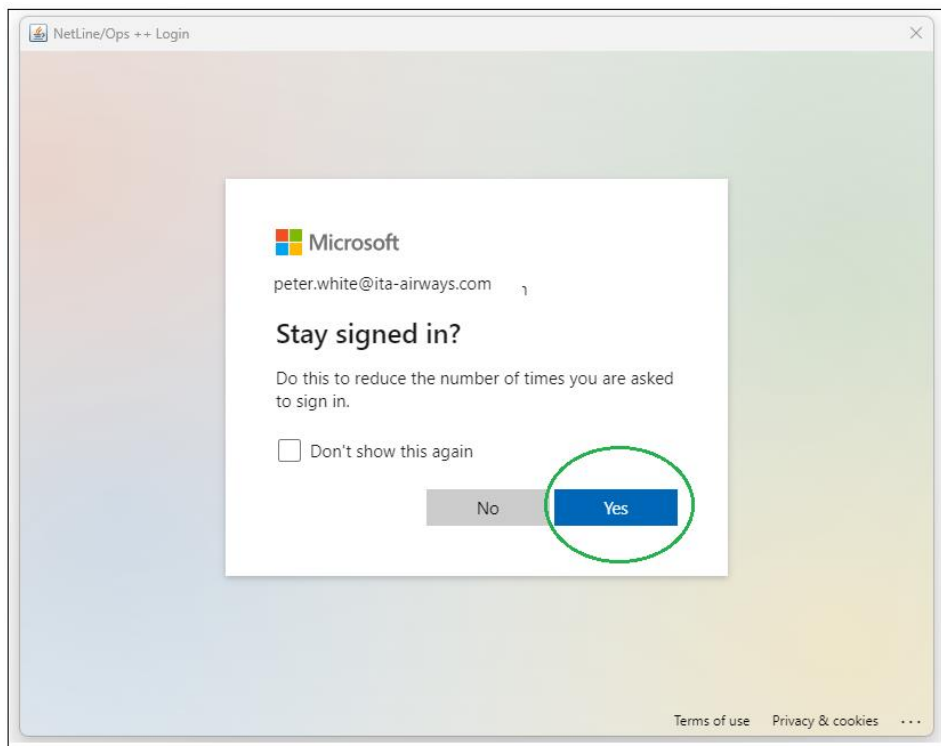

NetLine OPS++ (or NetLine OpsLink) will be initialized:

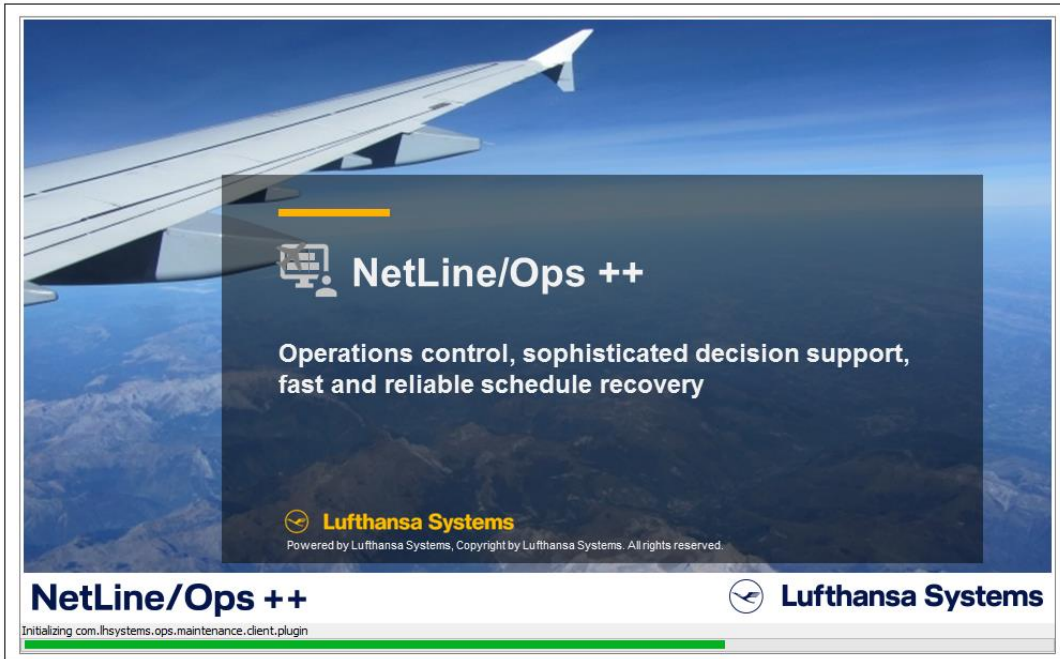

NetLine/Ops++ OpsLink UTC: 10:46

Home

Logout

Arrivals

Departures

Turnarounds

Legs

Checks

Movement

Gates & Info

Fuel

Airports

Aircraft

Preferences

Statistics

Help

Legs

Carrier(s)	<input type="text"/>	Departure airport	<input type="text"/>
Flight number(s)	<input type="text"/>	Arrival airport	<input type="text"/>
Departure date	From: <input type="text"/> (DDMMYY) <input type="text"/> (hhmm)	Aircraft Subtype(s)	<input type="text"/>
	To: <input type="text"/> (DDMMYY) <input type="text"/> (hhmm)	Registration(s)	<input type="text"/>
Service Type	<input type="checkbox"/> Include checks	Query Type	<input type="checkbox"/> Query by Actual times